

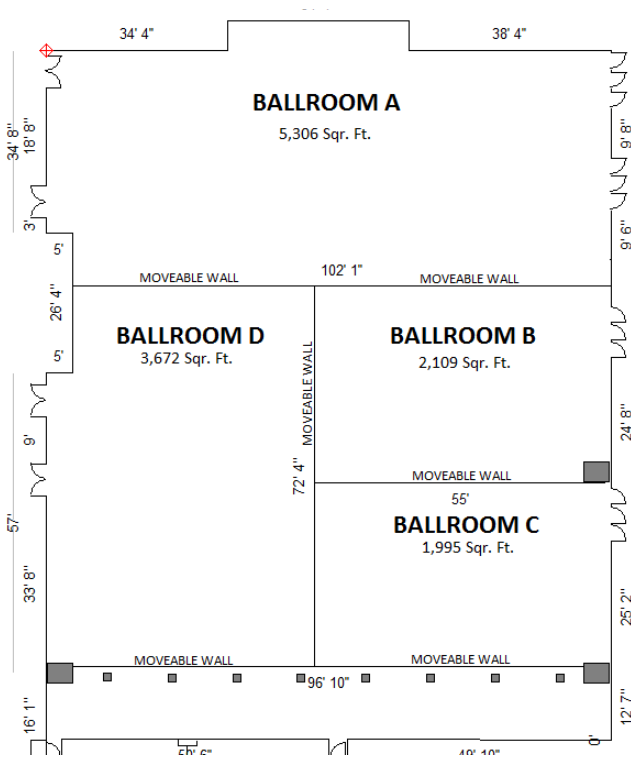

Old Layout

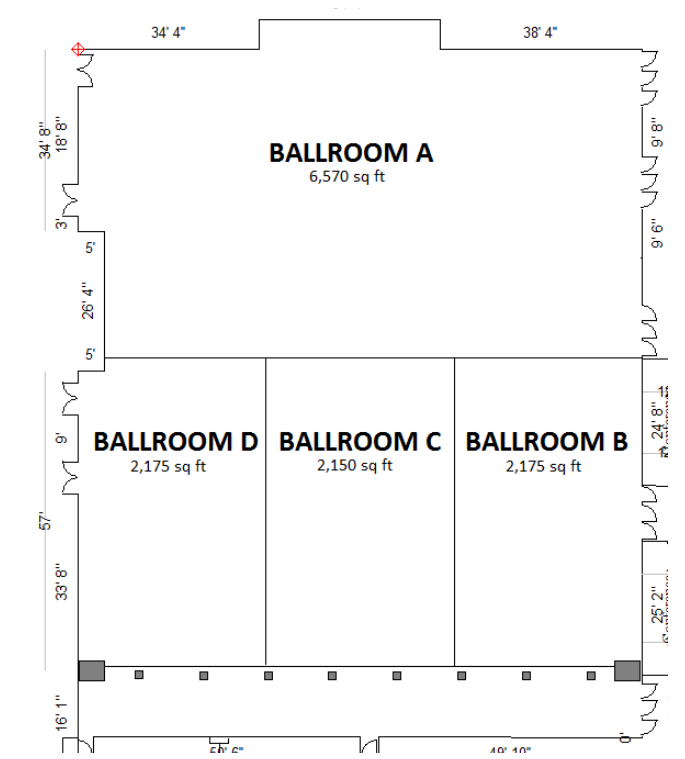

New Layout



NEW CAPACITY NUMBERS	THEATER (with stage)	ROUNDS OF 8 (with stage)	CLASSROOM (with stage)	U-SHAPE	SQUARE BOARD RM	UP TO 4 HOURS	MORE THAN 4 HOURS
Ballroom A	650	320	320	--	--	\$ 550	\$ 920
Ballroom B	200	96	96	48	56	\$ 180	\$ 300
Ballroom C	200	96	96	48	56	\$ 180	\$ 300
Ballroom D	200	96	96	48	56	\$ 180	\$ 300
Ballroom ABCD	1400	544	476	--	--	\$ 930	\$ 1,550
Ballroom ABC	1100	480	480	--	--	\$ 780	\$ 1,300
Ballroom ACD	1100	480	480	--	--	\$ 780	\$ 1,300
Ballroom BCD	700	296	288	110	132	\$ 465	\$ 775
Ballroom AB, AC or AD	750	400	400	--	--	\$ 625	\$ 1,040
Ballroom BC or CD	500	200	212	78	100	\$ 310	\$ 515

All setups are listed with no additional equipment that takes up floor space. For any additional equipment (buffet tables, a uction tables, band, dance floor, etc.), the total number of seats will be reduced.



New Equipment Pricing

Stage lighting package - \$50

Video Camera System - \$100 plus tech

42" Confidence monitors - \$35

On-site tech person - \$25/hr. plus set up time

Ballroom A projector - \$60 half, \$90 full day

Ballroom B,C, or D projector - \$30 half, \$50 full day

Front & Side Projector Package - \$100 half, \$150 full day

Complete package – Cameras, Projectors, lights and
tech - \$175/hr. including set up